

**Congratulations and Thank You for your purchase!** Fortis is an easy to install aluminum deck board with a tongue and groove hidden fastener system. Provided are general instructions for the installation of the 8" Fortis board. If there are any questions along the way please don't hesitate to call Customer Service @ (877) 270-9387 or visit the "Resource Library" at [www.wahoodecks.com](http://www.wahoodecks.com). Please read these instructions in their entirety before you start your project. **Please follow these steps closely to ensure the durability and safety of your deck.**

#### **Deck Structure Requirements:**

-The structural frame drawings in this guide are intended to illustrate the support requirements of Fortis and are not to be considered as a recommendation for actual deck construction. Always consult a professional engineer to ensure code compliance.

-Fortis will be fastened directly to the perimeter framing on all sides and all 16" on center common joist.

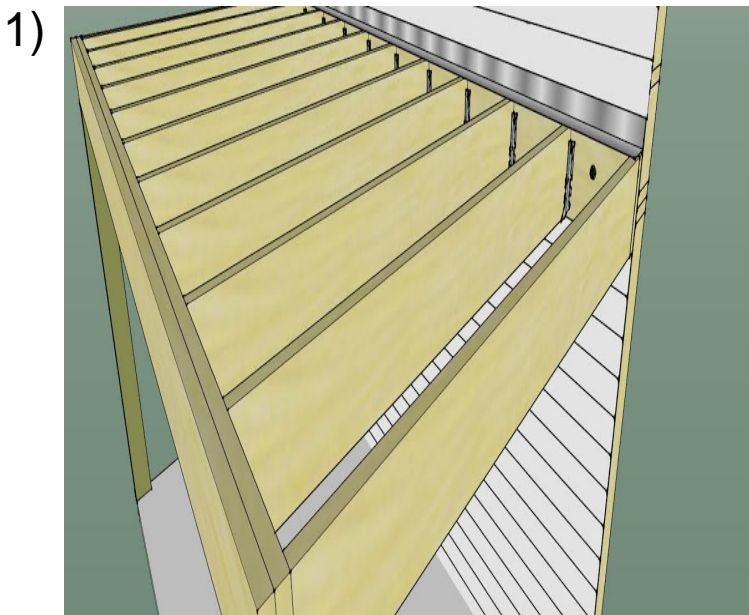

Sample Framing 8' x 13'



**Important!** Ensure that the ledger board and flashing have been secured properly and are free from debris such as protruding nails or screws.

#### **General tools needed for proper installation:**

- ✓ Tape Measure
- ✓ Drill & 5/16 Hex Drive Bit
- ✓ Skill Saw and/or Compound Saw
- ✓ Framing Square
- ✓ Safety Glasses and Gloves
- ✓ Carbide Tip Blades: 7¼" @ 62 teeth (skill saw) – 10" @ 80 teeth (table saw) – 12" @ 96 teeth (compound saw)
- ✓ Caulking Gun and Exterior Flashing Sealant
- ✓ Hammer / Rubber Mallet

## Components

### Fortis Board

The 8" wide and 1" tall board covers more space than most decking planks and because it can span 24" as opposed to 16", the savings on deck substructures makes Fortis more affordable. With grooved siding, Fortis is ready-made for a hidden fastener system.

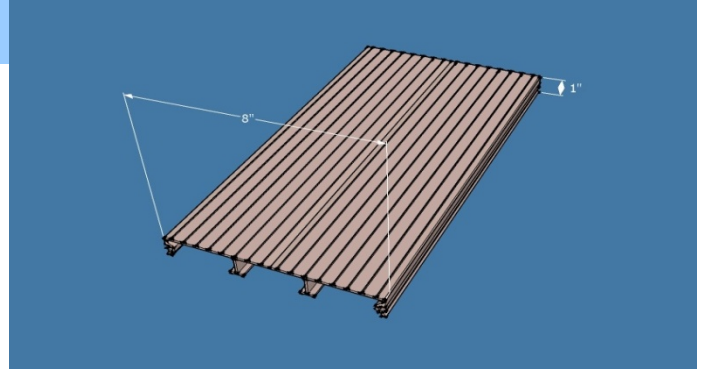

### Bracket

Fortis boards are secured by a hidden fastener system. The 1" tall brackets attach over joists and easily secure into Fortis' pre-grooved sides.

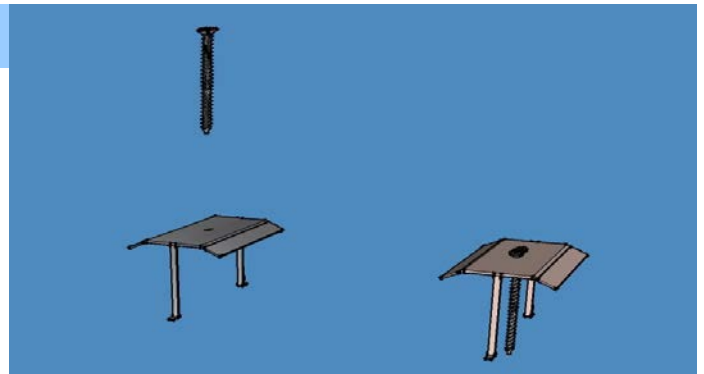

### Trim

Fortis trim can be in any length up to 24' and gives a finished appearance to the profile of Fortis.

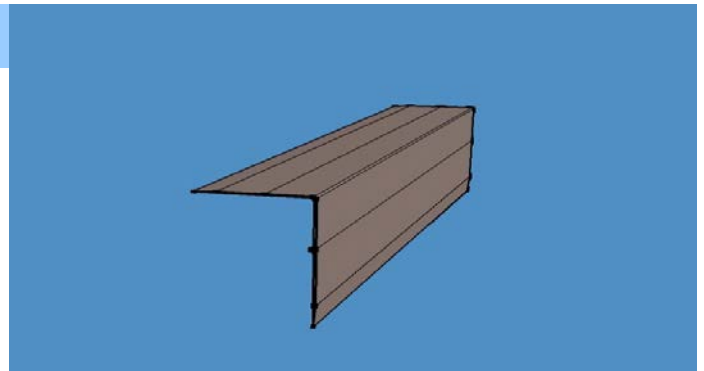

### 2x2 Rigid Flashing & Torx Trim Head Screws

Wahoo Decks provides a color matched rigid flashing for installation on top of the Fortis system. It measure 2" x 2" and is attached using the T-25 Torx Trim Head Screw.

The Rigid Flashing is installed up against the exterior of the structure.

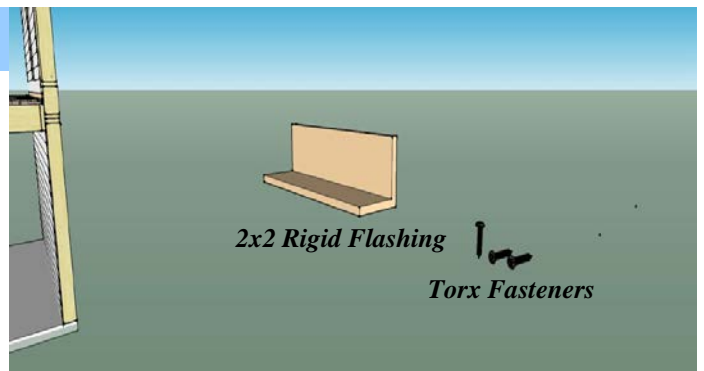

### STEP 1: Layout & Hidden Fastening System

Fortis deck boards can be cut to their desired length prior to installation or after installation. Wahoo recommends pre cutting to length with a stationary chop saw to ensure a clean cut with no obstructions.

To begin install the start board face mount near outer edge of Fortis board with stainless steel fastener.

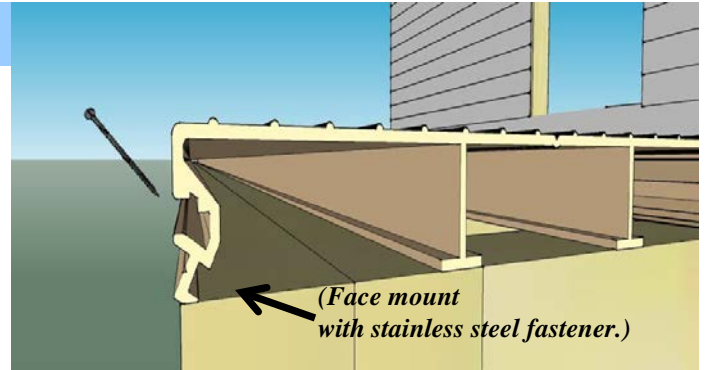

### STEP 2: Install Decking

After placing Fortis on the joist, attach the bracket over the joist and into Fortis' grooves.

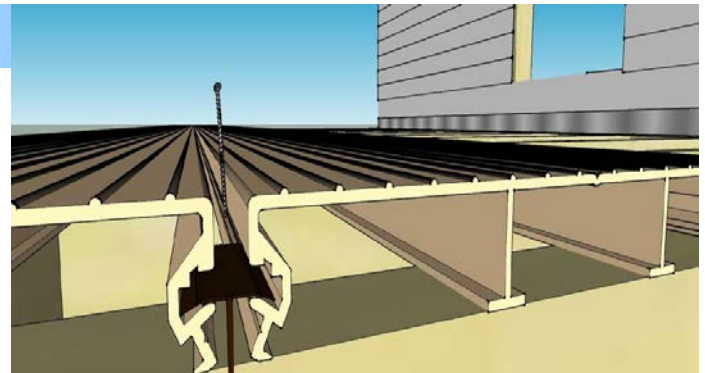

Using the provided Wahoo Trim Head secure the board with Fortis' fastener.

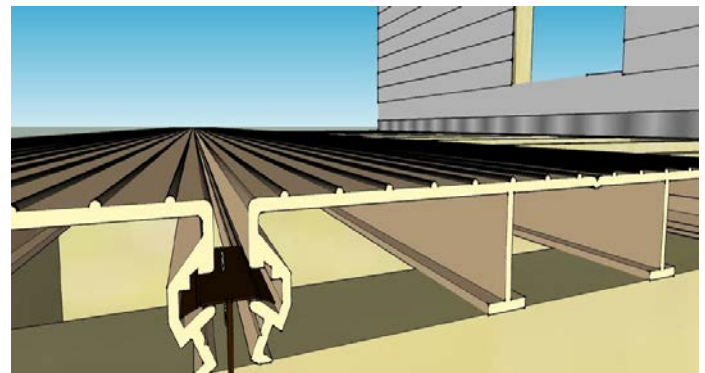

Repeat this step until reaching final board.

(See *Illustration C* and *Illustration D*).

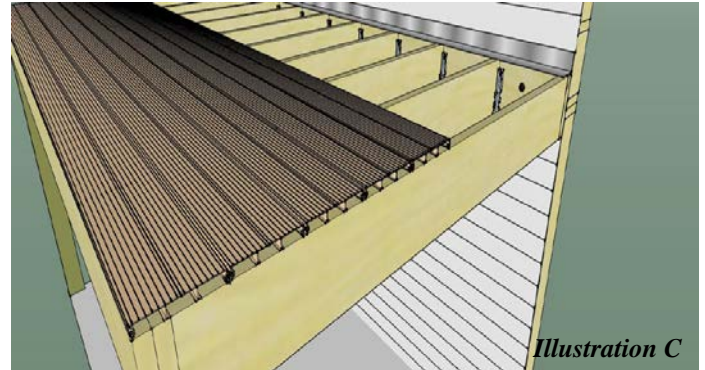

*Illustration C*

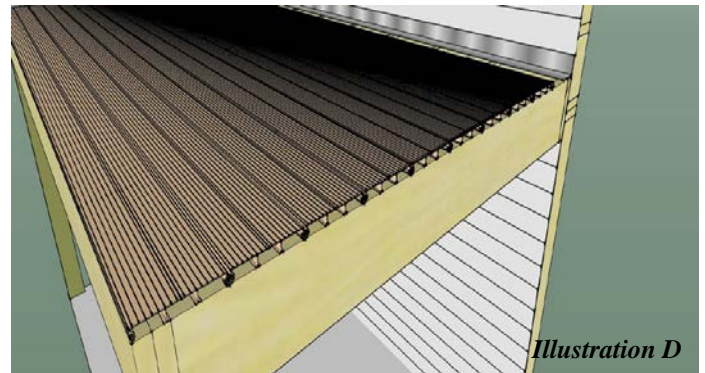

*Illustration D*

### STEP 3: Installing Final Board

When time to install the final board, face mount with a stainless steel fastener to the outer edge of the board.

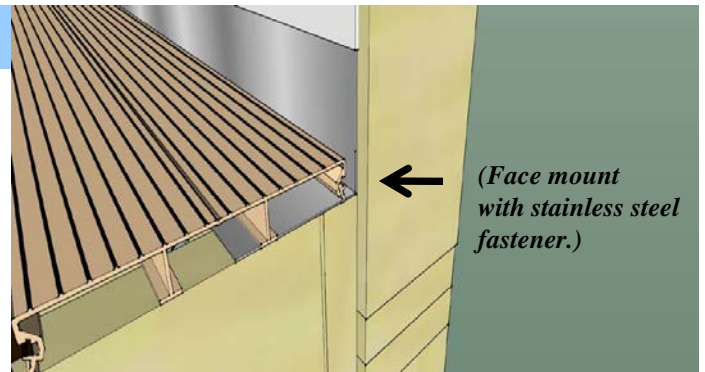

*(Face mount  
with stainless steel  
fastener.)*

### Installing Trim

Cover the edges of Fortis with its trim which will conceal the end view of the aluminum deck board.

(See *Illustration E* and *Illustration F*).

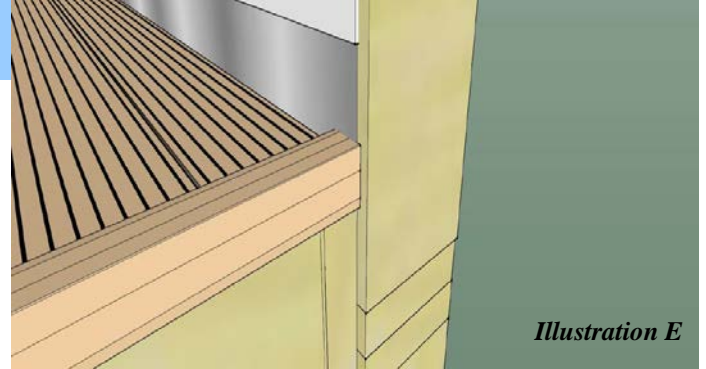

*Illustration E*

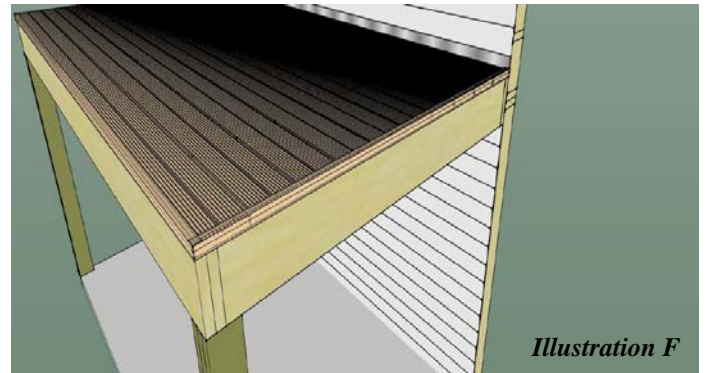

*Illustration F*

Using Torx Pan Head Screw install trim.

(See *Illustration G*, *Illustration H*, & *Illustration I*).



*Illustration G*



*Illustration H*

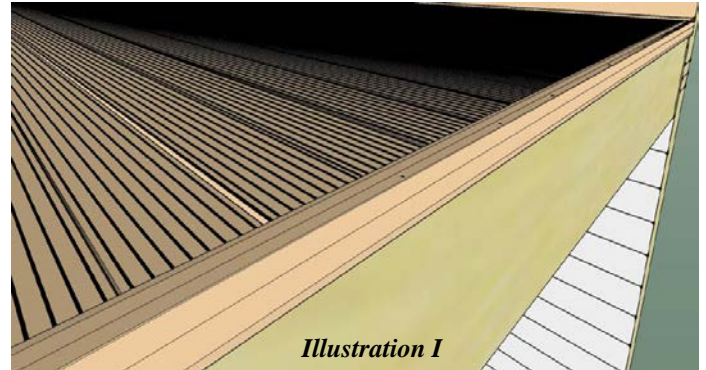

### Installing 2" x 2" Rigid Flashing

Using Torx Pan Head Screws, install the 2" x 2" Rigid Flashing to the exterior of the structure.

Always apply sealant to the back and bottom side of the Rigid Flashing prior to installation. **\*This flashing is in addition to, not in lieu of, standard ledger flashing.\***

It is ideal to install the Rigid Flashing behind the siding, if possible.

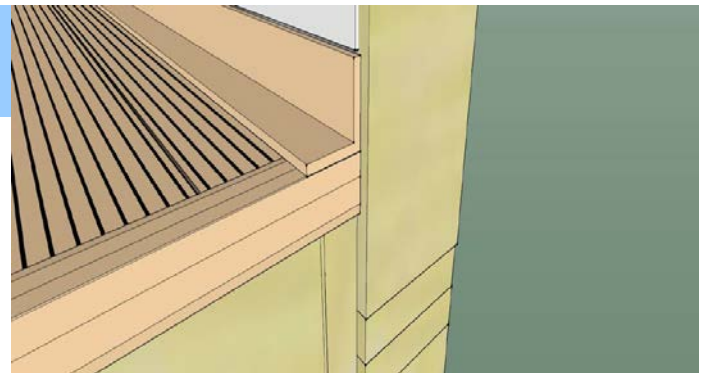

### Wahoo Rail Mount Installation

#### 3/8" Mill Finish Rail Mount

Mark and pre-drill the four mounting holes and use the supplied 3/8" Lag Bolts to attach the mill finish pedestal mount.



Install the 3/8" Lag Bolt into the additional timber blocking to the framing below the mill finish post mount.

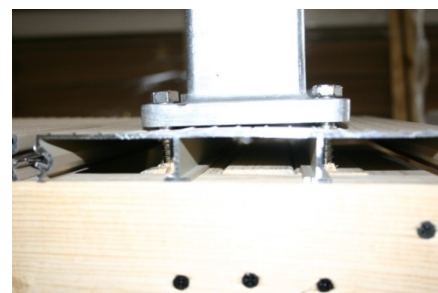

#### Installation of the 3/8" Lag Bolt

Add additional timber blocking to the framing below the mill finish post mount.



\*Refer to the "Wahoo Rail Install Guide" for complete rail installation details.\*

Please contact our customer service team at (877) 270-9387 with any questions. Wahoo Decks appreciates your business and we look forward to your feedback!

**Enjoy your new deck!**